



Passive Ventilation for Parapets – Stop Leaks, Dry Walls Quickly



Easy to Install, Flashing/Ventilation System

Patented WickRight Capstone Vented Receiver Clip, Capstone Vented Drip Edge and breathable, yet water resistant Vapor Permeable Membrane is a permanent passive ventilation system.

Installation protects parapets from water leaking through capstones. Wind blowing through the system's portals dries walls by drawing moisture vapor out of the masonry and wall core.

Capstone Vented Receiver Clip works with our Off-Set Counter Flashing to protect WickRight Low-Slope Roof Vent™ when installed as part of a complete wall and roof system. We have 52 Clip Coping installations in Chicago. Call for referrals or to visit a jobsite.

We provide free installation training and owner education to help you sell the right solutions to your customers.

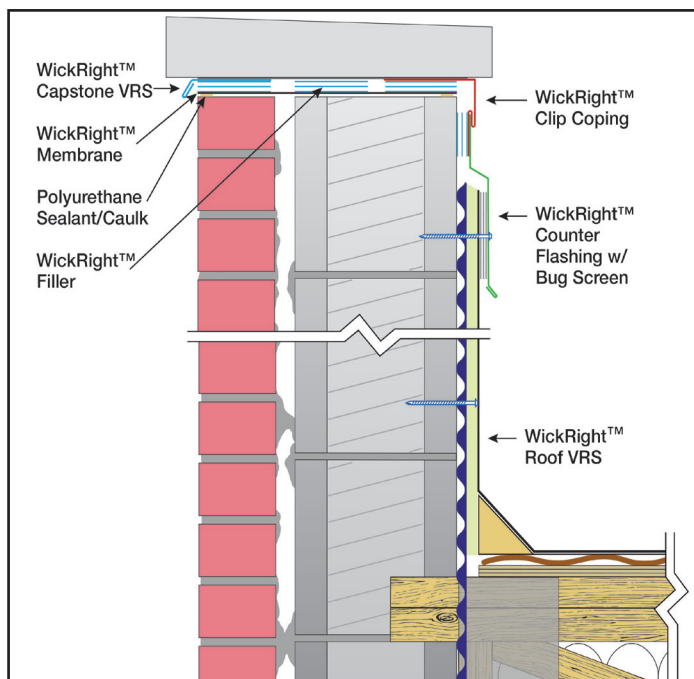

“Using the Capstone Vented Receiver Clip on the interior side of a parapet protects the wall and is a nice finished look. The counter flashing is easily removable, so WickRight Roof VRS can be installed later. This allows customers to do work in stages.”

— Bob Kelly, Master Carpenter/General Contractor,
Inventor/Partner, WickRight Inc.



7.2 cubic feet per minute per foot

18 MPH Wind Speed

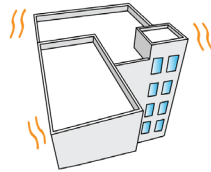

7.2 x 180 = 1296
cubic feet of airflow per minute

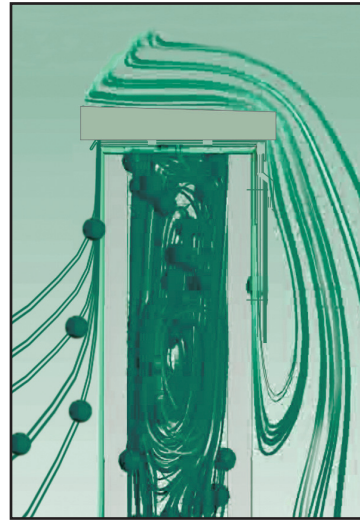

CFD simulation shows that Capstone Vented Drip Edge and Vented Receiver Clip increase airflow in parapet walls more than 7.2 cubic feet per minute per lineal foot with an 18 mph wind.

Streamlines show how air enters a wall via Capstone Vented Drip Edge on the exterior side of a wall, circulates inside the wall, then exits via Vented Receiver Clip on the interior side of the wall.



LIMITED WARRANTY

WickRight Vented Receiver Clip™

Available in 10' lengths

For use under Coping Stones or Capstones on parapets of any width or material, including CMU, brick, frame or any combination of these materials.

Vented Receiver Clip is installed on the **interior** side of a parapet, Capstone Drip Edge is installed on the **exterior** side.

Vented Receiver Clip acts as a vent, flashing and receiver clip for standard counter flashing or exaggerated counter flashing to better protect the interior side of the wall.

In-Stock Clip and Counter Flashings are made with Stainless Steel. Custom metal choices available.

How to Order Clip Coping VRS: Measure perimeter, add 10%.

WickRight Membrane installation required prior to installing Vented Receiver Clip and Capstone Vented Drip Edge.

In-Stock Membrane rolls – 300' long x 9" wide, 15" wide or 20" wide. Custom widths available.

WickRight Capstone Filler recommended on walls 10-11" wide, required on walls 12" or wider.

In-Stock Filler – 4' long x 2", 3", 4" or 5" wide. Custom widths available.

Off Set Counter Flashing required when WickRight Low-Slope Roof Vent is also installed.



WICKRIGHT VENTED RECEIVER CLIP™

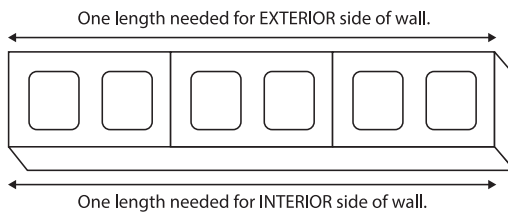
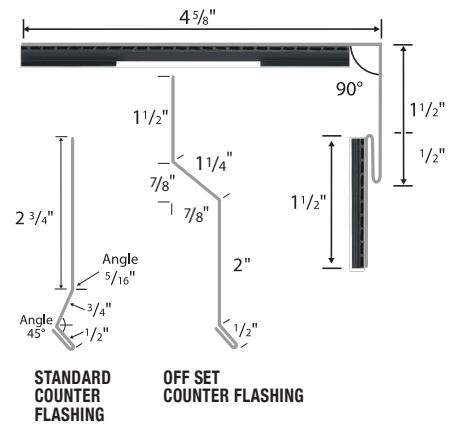

CAPSTONE VENTED DRIP EDGE™

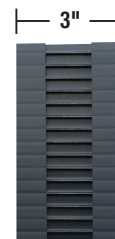

CAPSTONE FILLER

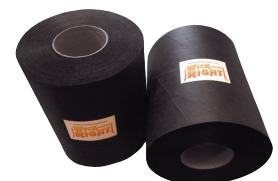

VAPOR PERMEABLE MEMBRANE

View our online store at www.WickRight.com/store

We accept company checks, credit cards, Chase Quick Pay and Zelle.



312-720-1467 www.WickRight.com info@wickright.com